

S153 Safety valve

- Protect systems against over pressure
- Set pressure up to 450 bar
- Cat. 4 safety valve according to PED 2014/68/EU



Technical features

Medium:
Hydrogen

Applications:

- Hydrogen Refueling Station
- Gas distribution/mixing
- Pressure test rigs
- Marine industries
- Off shore / aggressive environments
- Compressor regulation
- Air, O₂, CH₄ compressor

Medium:
H₂, air, N₂, O₂, Ar, CH₄, C₂H₂, CO₂, N₂O, etc.

Maximum inlet pressure:
450 bar

Set pressure range:
8 ... 450 bar (116 ... 6.527 psi)

Valve body pressure rating:
Brass 280 bar
Stainless steel 450 bar

Leakage:
Internal leakage: <10-3 mbar.l/ sec
External leakage: <10-4 mbar.l/ sec

Weight:
1,2 kg

Ambient/Media temperature:
-20 ... +50°C (-4 ... +122°F)(NBR)
-40 ... +99°C (-40 ... +210°F) (EPDM)
Seat Diameter:
5 mm

Material:
Body: Brass, Stainless steel
Valve insert: PCTFE, Peek or stainless steel
Seat: Stainless steel, PTFE, Nitrile, FPM, EPDM
O-ring: NBR, EPDM, FPM

Technical data – standard models

Symbol	Set pressure range		Rubber material	Poppet material	Seat material	Model
	(bar)	(psi)				
	27 ... 60	392 ... 870	NBR	PEEK	Stainless steel	S 153 I T 37 N P I 1000
	50 ... 130	725 ... 1.885	NBR	PEEK	Stainless steel	S 153 I T 46 N P I 1000
	100 ... 200	1.450 ... 2.901	NBR	PEEK	Stainless steel	S 153 I T 54 N P I 1000
	175 ... 340	2.538 ... 4.931	NBR	PEEK	Stainless steel	S 153 I T 68 N P I 1000
	280 ... 450	4.061 ... 6.527	NBR	PEEK	Stainless steel	S 153 I T 73 N P I 1000

Option selector

S153*****

	Substitute
Body Material	
Stainless steels	I
Brass	L
Max. Working pressure	
35 bar	E
280 bar	M
450 bar	T
Response Pressure Setpoint Range	
8 ... 17 bar Spring R3,5	27
15 ... 30 bar Spring R4,5	30
27 ... 60 bar spring R3	37
50 ... 130 bar Spring R3,5	46
100 ... 200 bar Spring R4,5	54
175 ... 280 bar Spring R5,3	77
175 ... 340 bar Spring R5,3	68
280 ... 450 bar Spring R5, 6	73
O-Ring type	
Nitrile O-ring / Cleaning procedure P902	N
EPDM O-ring / Cleaning procedure P902	E
Valve insert	
PCTFE	K
Stainless steel	I
PEEK	P
Seat Material	
Stainless Steel	I
PTFE	U
Nitrile	N
FPM	V
EPDM	E

Main options	Substitute
Standard version 3/8" BSP	1000
1/2" BSP male adaptor on the inlet port	1078
3/8" NPT thread	1145

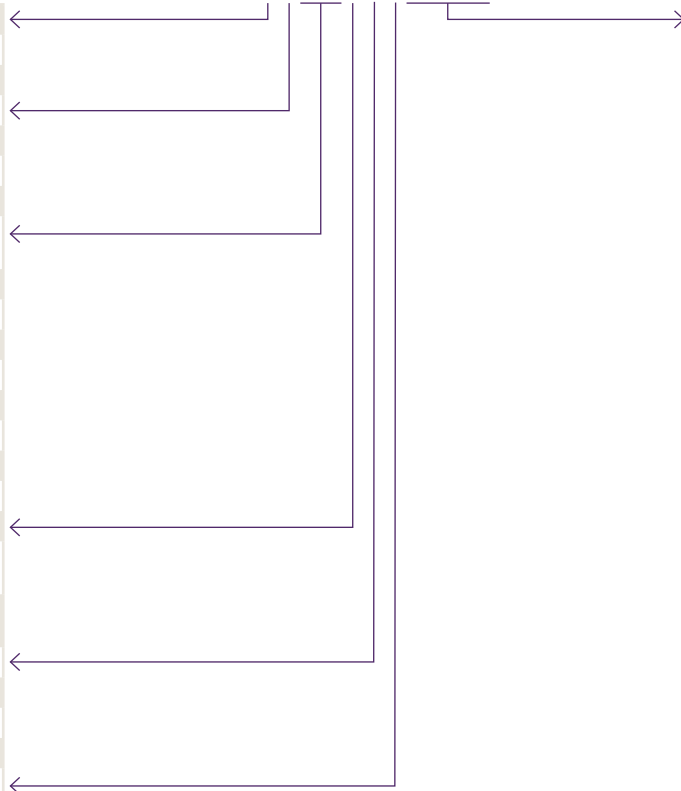

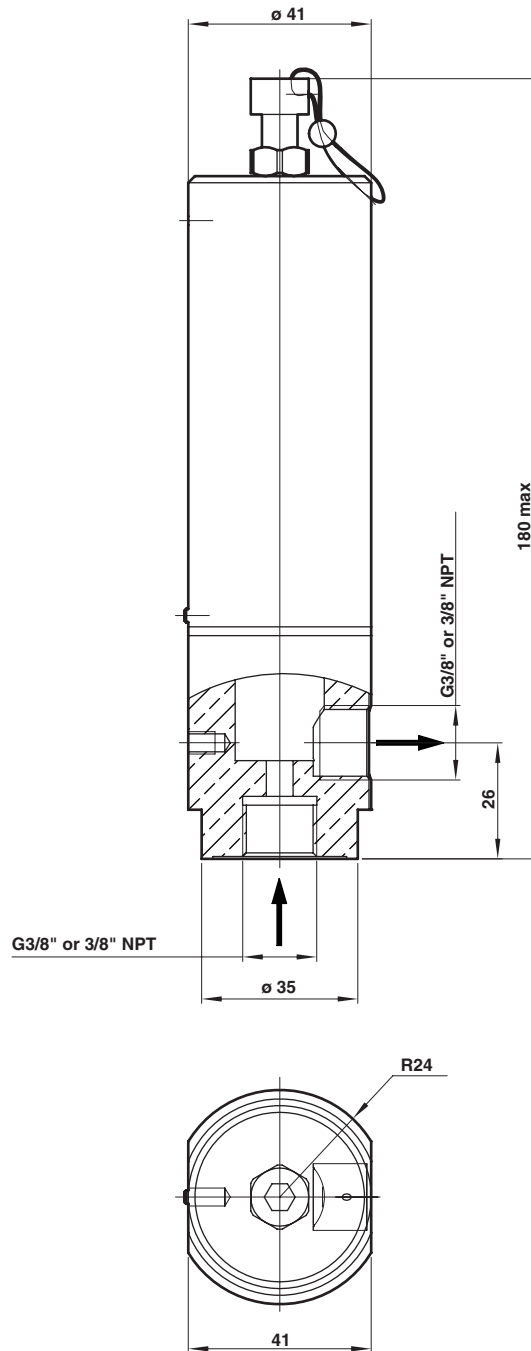

Warning

Do not use these products where pressures and temperatures can exceed those listed under »**Technical features/data**«. Before using these products with fluids other than those specified, for non-industrial applications, life-support systems or other applications not within published specifications, consult IMI, IMF sas.

Through misuse, age, or malfunction, components used in fluid power systems can fail in various modes.

The system designer is warned to consider the failure modes of all component parts used in fluid power systems and to provide adequate safeguards to prevent personal injury or damage to equipment in the event of such failure. System designers must provide a warning to end users in the system instructional manual if protection against a failure mode cannot be adequately provided.

System designers and end users are cautioned to review specific warnings found in instruction sheets packed and shipped with these products.